

Medicine Hat Catholic Board of Education

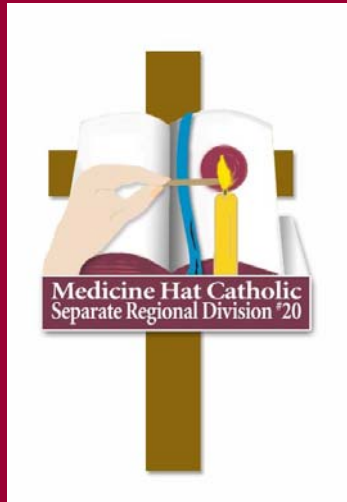

PUBLIC AGENDA

Tuesday, December 13, 2016 @ 6:00 p.m.

Catholic School Board Office
1251 – 1st Avenue SW Medicine Hat, AB

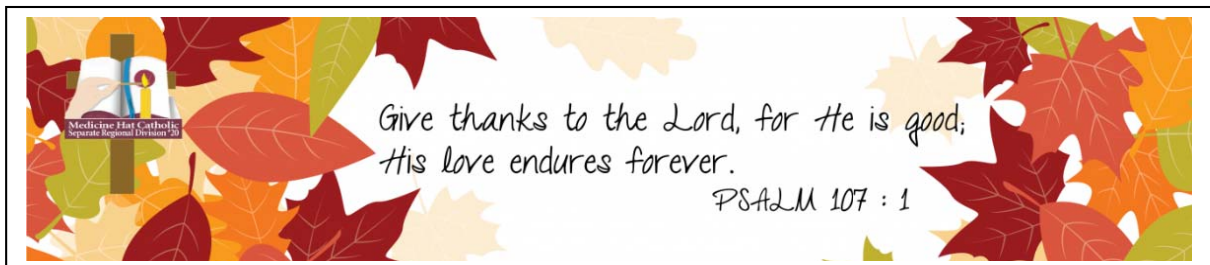

Medicine Hat Catholic Board of Education

ACTION AGENDA

DATE: December 13, 2016

Place: Catholic Education Centre

Time: 6:00 p.m.

	<p>WE ARE CALLED Always and Everywhere to: Model Christ, Pray and Serve, Build a Faith Community</p> <p>Theme for 2016-2017: BLESSINGS FROM GOD</p>		
1.	<p><i>Opening Prayer – Blessing before a Meeting</i> <i>Lord, bless us as we gather today in your name. Send us the guidance of your Spirit to bring us wisdom and understanding. Help us to open our minds and our hearts so that we may listen respectfully to the viewpoints of others and make decisions in accordance with your will. Help us to grow in faith so that we may serve you and others in all that we do. We ask this grace through Christ our Lord. Amen.</i></p>	Peter Grad	
2.0	<p><i>Approval of the Minutes Regular Board Meeting</i> <u>♦ Recommendation:</u> “THAT the Minutes of the Regular Meeting held November 08, 2016 be approved as circulated”.</p>	Dick Mastel	
2.1	<p><i>Approval of the Minutes of the Special Board Meeting</i> <u>♦ Recommendation:</u> THAT the Minutes of the Special Meeting November 23, 2016 be approved as circulated.</p>	Dick Mastel	
3.	<p><i>Approval of the Action Agenda</i> <u>♦ Recommendation:</u> “THAT the Action Agenda dated December 13, 2016 be approved as circulated”.</p>	DM	<i>Encl. 1-4</i>
4.	<p><i>Approval of the Non-Action Agenda</i> <u>♦ Recommendation:</u> “THAT the Non-Action Agenda dated December 13, 2016 be approved as circulated”.</p>	DM	<i>Encl. 5</i>
5.	<p><i>Presentations</i> -School Education Plan Presentations <u>5.1 Ecole St. Thomas d’Aquin – School Education Plan</u> <u>5.2 St. Patrick’s School- School Education Plan</u></p>	DM/JC	<i>Handout</i>
6.	<p><i>Corporate Communications</i> <u>6.1 Medicine Hat Women’s Shelter – Thank You Letter</u> <u>6.2 5th Trustee & Ward Public Consultation Open House-Dec 13th</u> <u>6.3 Christmas Concerts in MH Catholic Schools</u> December 2016 13 St. Mary’s Christmas Concert, MH College Eresman Theatre, 7:00pm, \$5.00 @ tixx.ca 15 St. Michael’s Christmas Concert, MH College Eresman Theatre, 7:00 pm, Free 19 Notre Dame Academy Christmas Gala, Notre Dame Academy, 6:00 pm, Free 20 St. Patrick’s K-2 Christmas Concert, St. Patrick’s School, 10:30 am/1pm/6:30pm, Free 20 École St. Thomas Christmas Concert, Dream Centre, 6:00 pm, Free</p>	DM	<i>Encl. 6 7</i>

11.	<i>Associate Superintendent Human Resources – Mr. Chuck Hellman</i> <i>11.1 2017 – 2018 School Year Calendar</i> <i>11.2 School Visits</i>	CH	(Report) 37 38
12.	<i>Secretary-Treasurer Report – Mr. Greg MacPherson</i> <i>12.1 2016 – 2017 Infrastructure Maintenance Renewal (IMR) Plan</i> <i>12.2 First Quarter 2016 -2017 Financial Update</i> <i>12.3 Notre Dame Academy Outdoor Fitness Area</i> <u>Recommendation:</u> “THAT the Board of Trustees for the Medicine Hat Catholic Board of Education approve the use of \$50,000 from the Internally Restricted Reserve for the purchase of the Outdoor Fitness Equipment at Notre Dame Academy”. <i>12.4 St. Mary’s School – Budget Update</i> <u>Recommendation:</u> “THAT the Board of Trustees for the Medicine Hat Catholic Board of Education approve the use of \$16,500 from the Internally Restricted Reserve for the use at St. Mary’s School for Furniture and Equipment and School Purchased Teacher FTE”.	GM	(Report) 39 – 40 41 - 46
13.	<i>Associate Superintendent Learning Services – Mr. Hugh Lehr</i> <i>13.1 No Items</i>	HL	(Report)
14.	<i>Director of Early Childhood Services – Mrs. Kym Porter/Mrs. Terri Ball</i> <i>14.1 PUF Application to Alberta Education</i>	KP/TB	(Report) 47
15.	<i>Religious Education Coordinator Report – Mrs. Jill Wilkinson</i> <i>15.1 Religious Education “New” Curriculum</i> <i>15.2 Volunteer Interest Form for Parish Community</i>	JW	(Report) 48 49
16.	COMMITTEE REPORTS (presented by appointed Trustees)	DM	
	16.1 Medicine Hat Catholic Schools’ Education Foundation – <i>Mrs. Regina Durst</i>		
	16.2 Representative to ACSTA– <i>Mr. Dick Mastel</i>		
	16.3 Representative Teacher Board Advisory Committee – <i>Reverend Mr. Robert Risling</i>		
	16.4 Representative to ASBA Zone 6 – <i>Mr. Peter Grad</i>		
	16.5 Representative to Support Staff Board Advisory Committee– <i>Mrs. Regina Durst</i>		
	16.6 Representative to Parent Association– <i>Mr. Peter Grad</i>		
	16.7 Salary Negotiations 16.7.1 ATA– <i>Mr. Peter Grad</i> 16.7.2 CUPE– <i>Mr. Dick Mastel</i>		
	16.8 CUPE Staff Board Advisory Committee – <i>Reverend Mr. Robert Risling</i>		
	16.9 Spiritual Leadership Scholarship Board Representative – <i>Mrs. Regina Durst</i>		
	16.10 Student Board Advisory Committee – <i>Mr. Dick Mastel</i>		
	16.11 C2 (Adhoc) Committee – <i>Reverend Mr. Robert Risling</i>		
	16.12 Monsignor McCoy Modernization (Adhoc) Committee – <i>Mrs. Regina Durst</i>		
	16.13 School Parish Relations Committee (Adhoc) Committee – <i>Mr. Robert Risling</i>		
17.	<i>Closing Prayer</i> <i>Lord, we come to you today to seek the peace that you alone can give.</i> <i>Strengthen us in our work as we seek to build a peaceful community.</i> <i>Amen</i>	Peter Grad	
18.	<i>Adjournment</i>	Dick Mastel	

NON – ACTION AGENDA

DATE: Tuesday, December 13, 2016 Place: Catholic Education Centre Time: 6:00 P.M.

No.	INFORMATION ITEMS	PAGE
1.1	<p><u>REGISTRATION 2017 - 2018</u></p> <p>* Watch for our UPCOMING FEBRUARY 2017 REGISTRATION in all Catholic schools in Medicine Hat for the 2017 - 2018 school year.</p> <p><u>ALL ARE WELCOME–</u> <i>Are you a new resident to this country or new to our community or have a new learner getting ready to start school?</i> Did you know that Catholic Schools in Alberta are publicly funded? That means, while we have school fees, there is no tuition. Our Schools offer a faith filled education. We nourish the whole child, spiritually, socially and academically and all are welcome! Call us for information or to register in one of our nine Schools in the City of Medicine Hat. MEDICINE HAT CATHOLIC BOARD OF EDUCATION – 403.527.2292 or www.mhcbe.ab.ca. Come, Experience Catholic Schools - “Showing the Face of Christ to All”.</p>	
1.2	<p><u>TAXES – DECLARE YOUR SUPPORT for CATHOLIC SCHOOLS</u> – <i>The Medicine Hat Catholic Board of Education</i> reminds our community of the importance of declaring your PROPERTY TAXES in support of Catholic Education How do you declare your support? - To ensure your property taxes are supporting Catholic Schools, you must declare your Catholic school support as “Separate” on your annual property assessment notice. <i>Contact the Taxation Office at the City of Medicine Hat, or the Town or Municipal Office in your area.</i> Changes made on or before Dec 31 will be in effect for the next taxation year. Thank you for your supporting Catholic Schools.</p>	

Notice of Public Board Meetings

- All regularly scheduled Public Board Meetings are the **2nd Tuesday** of each month held at the Catholic Education Centre located at 1251 – 1st Avenue SW (unless otherwise advertised).
- Public Board Meetings for the Medicine Hat Catholic Board of Education will begin at **6:00 pm** with **presentations at 6:00 pm** (unless otherwise advertised).
- **General Public welcome to attend - Information @ www.mhcbe.ab.ca**



Medicine Hat Women's Shelter Society
Box 2500, Medicine Hat, AB T1A 8G8
Phone: (403) 527-8223

November 15, 2016

Medicine Hat Catholic Board of Education
1251 1 Ave SW
Medicine Hat, AB T1A 8B4

Dear Friends of the Shelter,

The Medicine Hat Women's Shelter Society gratefully acknowledges your kind support through your recent Donation Drive. We were thrilled to receive so many thoughtful gifts for our families and your generosity means that we are able to continue providing our programs and services to all families who need help rebuilding their lives free from violence.

Thank you so very much for your support. Your donation is already making a difference in the lives of the women and children we serve!

Yours truly,

Natasha Carvalho, M.Sc., RSW
Executive Director



Medicine Hat Catholic Board of Education

FIFTH TRUSTEE & WARD - PUBLIC CONSULTATION

Open House and Invitation to Comment

Tuesday, December 13th
from 5:00pm-6:00pm

1251- 1ST AVE SW, MEDICINE HAT
CATHOLIC SCHOOL BOARD OFFICE



MEDICINE HAT CATHOLIC - OPEN HOUSE

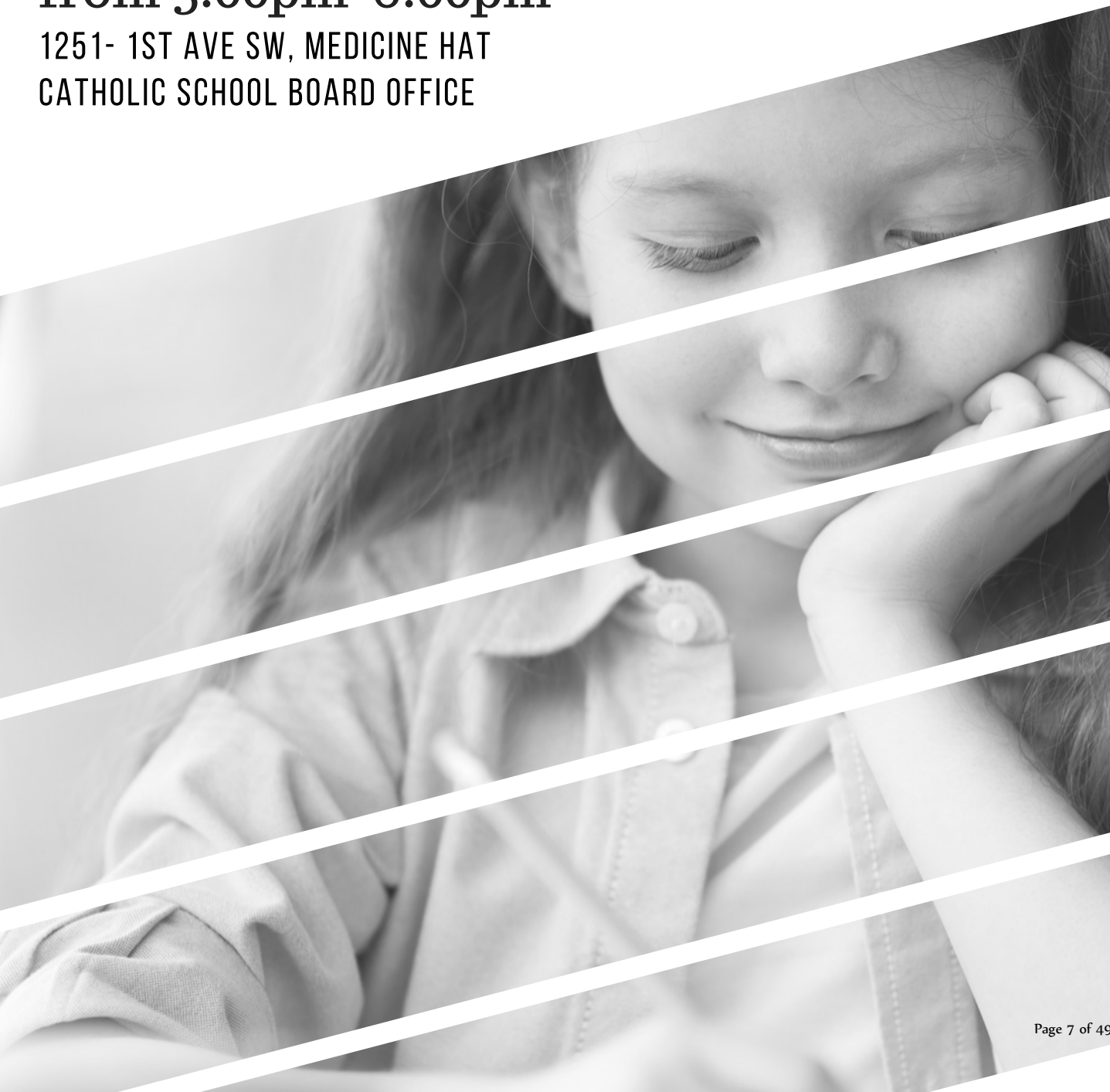

HAVE YOUR SAY!

The Medicine Hat Catholic Board of Education is seeking to add a fifth Trustee to the Board for the October 2017 Alberta School Board Election *and* to consult with our community about the Ward system. We want to hear from YOU!

Why do we want to add a fifth Trustee?

The Board sees the addition of a fifth School Board Trustee as a positive move as it will:

- Allow for greater division of responsibilities;
- Reduce the likelihood of split votes;
- Provide another voice in discussions;
- Re-establish the number of Trustees prior to the Bow Island Ward withdrawal in 2014.

Is our community satisfied with One Ward serving our Catholic Schools?

- A Ward is a local authority area, typically used for electoral purposes. Currently, Medicine Hat Catholic Schools are served by One Ward. That means, all Trustees serve the entire jurisdictional area including Medicine Hat, Dunmore, Redcliff & surrounding rural areas within our jurisdictional boundaries.

All are Welcome!   

We want to hear your thoughts!
Come to the Open House or send your comments to
communications@mhcbe.ab.ca by Dec 21st or call
403.527.2292 for more information.

Modernization of Monsignor McCoy – Standing Item
Board Report December 13, 2016 Public Meeting

1. Monsignor McCoy Modernization Update

Senior Administration will provide an update on the modernization of Monsignor McCoy.

Recommendation: Receive as information.

Attachment: Attached

St. John Paul II School Construction – Standing Item
Board Report December 13, 2016 Public Meeting

1. St. John Paul II School Update

An update will be provided

Recommendation –None

Attachment: None

Superintendent Report
December 13th, 2016
Board Meeting

Regular Meeting

1. CCSSA Marks of an Excellent Catholic Leader

The attached CCSSA Marks of an Excellent Catholic Leader document was approved as a CCSSA resource at the November 17 CCSSA meeting. The document will be reviewed with the Division Leadership Team at the January DLT meeting.

Purpose of the Document

The document has been created as a supplementary resource for leaders in Catholic Education. Building on the document *The Excellent Catholic Teacher* (CCSSA, 2015), *The Marks of an Excellent Catholic Leader* begins with the premise that superb Catholic school leaders are also master Catholic teachers. While embracing the essence of teaching excellence, this treatise goes beyond teaching to address the roles and responsibilities of both Catholic school and Catholic district leaders.

HOW MIGHT THIS DOCUMENT SERVE CATHOLIC SCHOOLS IN ALBERTA?

This Catholic leadership framework may be used to:

- Inspire Catholic leaders in their service of Catholic education
- Offer a role description for Catholic leaders
- Provide indicators and offer exemplars
- Create conversations around Catholic leadership
- Assist leaders as they strive for excellence in their vocation
- Serve as a resource when identifying, recruiting and hiring Catholic school leaders

Recommendation: Receive as information and discussion

Attachment: CCSSA Marks of an Excellent Catholic Leader

2. Student Code of Conduct – Draft

Following our commitment to provide welcoming, caring, respectful and safe learning environments a committee made up of senior admin and school based administrators have met three times to review and develop a common Division Student Code of Conduct that could be used by each of the schools. Following the requirements of the School Act and ASBA guidelines as a reference we have now completed our **second draft**. Thank-you to the administrators that submitted suggestions after our last DLT meeting. The latest draft of Student Code of Conduct was also reviewed with the Parent Association. It would be my intention to have the **Student Code of Conduct** reviewed by the DLT one last time at their January meeting and then it would become a Division wide approved document for all schools.

Recommendation: Receive as information

3. Kev Soft update

School Cash Online is a tool our District uses that allows parents to make purchases online. It is a safe, fast and convenient way to pay for school fees, activities, field trips, hot lunches, events and more! Payment options include credit card, E-Cheque (similar to a debit transaction) and My Wallet (similar to a preloaded Starbucks card).

It is now MHCBE's preferred method of payment as it minimizes the amount of time the school secretary spends counting cash, recording transactions and taking deposits to the bank. We have made an FAQ available on the homepage of the Districts website. Clicking on the shopping card on any of the District or schools' website will take you directly to the School Cash Online website where you can get started.

All of our schools have made their school fees available to pay using School Cash Online and most are in the process of using the system for Early Learning Program fees, Before and After School Care fees, spirit wear and hot lunches. As some of these events/processes are largely administered by the school's Parent Council (i.e. hot lunches) we suggested they discuss with their school principal and secretary as to how School Cash Online can work for their next hot lunch/fundraiser, etc.

1,111 students are currently using Kev Soft. This represent **42.15%** of the student population. Some highlights include Ecole St. Thomas d'Aquin achieving 100% adoption and St. Francis Xavier is at 86% adoption.

Recommendation: Receive as information

4. International Trip – McCoy Baseball team to Phoenix Arizona

Monsignor McCoy is requesting approval to take the Monsignor McCoy Baseball Team on a trip to Phoenix Arizona from April 15th to April 22nd 2017. The Field Trip Assessment Committee has met and reviewed their request. I will review the details of this international trip at the Board meeting.

A recommendation for approval will be brought forward.

Recommendation: Receive as information and approval

CATHOLIC EDUCATION: Marks of an Excellent Catholic

Leader

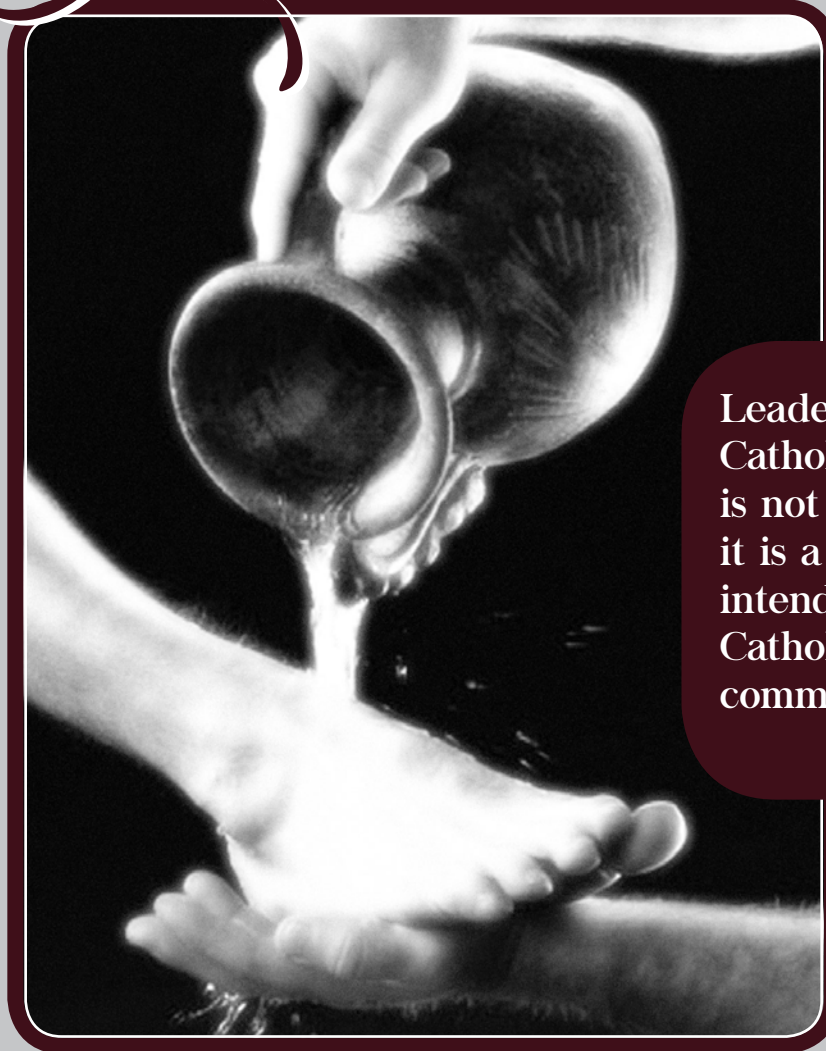

Leadership in
Catholic education
is not a career;
it is a vocation...
intended to serve the
Catholic education
community.

Mulligan

The Marks of an Excellent Catholic Leader



PURPOSE OF THIS DOCUMENT

This document has been created as a supplementary resource for leaders in Catholic Education. Building on the document *The Excellent Catholic Teacher* (CCSSA, 2015), *The Marks of an Excellent Catholic Leader* begins with the premise that superb Catholic school leaders are also master Catholic teachers. While embracing the essence of teaching excellence, this treatise goes beyond teaching to address the roles and responsibilities of both Catholic school and Catholic district leaders.

HOW MIGHT THIS DOCUMENT SERVE CATHOLIC SCHOOLS IN ALBERTA?

This Catholic leadership framework may be used to:

- Inspire Catholic leaders in their service of Catholic education
- Offer a role description for Catholic leaders
- Provide indicators and offer exemplars
- Create conversations around Catholic leadership
- Assist leaders as they strive for excellence in their vocation
- Serve as a resource when identifying, recruiting and hiring Catholic school leaders

For those of you in leadership positions—the Catholic community presumes and depends on your administrative competence, but also seeks from you leadership and vision beyond that of the professional educator. What is needed is leadership that is rooted in spirituality and calls forth spiritual growth from others.

Mark 1

AN EXCELLENT CATHOLIC LEADER EMBRACES THE DIGNITY OF ALL AS CREATED IN THE IMAGE OF GOD.

ROLE OF THE LEADER:

An excellent Catholic leader is responsible for ensuring the overall development of the whole person, by:

- Founding all aspects of the Catholic School on Jesus Christ, the Redeemer
- Recognizing and celebrating the gifts and talents of others
- Identifying and empowering key leaders who can ensure that the faith community flourishes
- Discerning an appropriate response to difficult situations using a personal and pastoral approach
- Ensuring that relationships are respectful and life giving
- Providing faith formation opportunities for staff and students
- Allocating resources to support and enhance the well being and the physical, emotional, academic and spiritual development of staff and students
- Integrating the message of eternal destiny into vision and mission

Leaders are also responsible for effectiveness by being enablers. They need to enable others to reach their potential both personally and institutionally...It begins with believing in the potential of people and trusting in the diversity of their gifts.

Palestini



Mark 2

AN EXCELLENT CATHOLIC LEADER ADVOCATES FOR CATHOLIC EDUCATION WITHIN AND BEYOND THE SCHOOL COMMUNITY AND MAKES DECISIONS ROOTED IN GOSPEL TEACHINGS.

ROLE OF THE LEADER:

An excellent Catholic leader is responsible for expressing and developing a living Catholic vision of the world by:

- Ensuring that all that happens in the Catholic school reflects a Catholic worldview
- Allocating time and resources to reflect Catholic priorities
- Articulating the spirit and teaching of the Catholic Church in order to inform policy and practice
- Speaking with one voice on matters of Catholic education by engaging with other Catholic leaders
- Developing and maintaining partnerships with other Catholic institutions, organizations and outreach groups
- Sharing and promoting Catholic education with non-Catholics
- Honoring, recognising and articulating the role of the Bishop's pastoral leadership in matters of Catholic education
- Visioning and creating physical spaces that visibly express the external signs of our Catholic faith
- Demonstrating a knowledge of local, national, and global issues and trends related to Catholic Church
- Encouraging members of the Catholic school community in their role as stewards of the environment

When a Catholic worldview permeates a school's life, then it is the driving force behind every activity, so that the Church's mission may be served effectively.

Archbishop Miller



Mark 3

AN EXCELLENT CATHOLIC LEADER INTENTIONALLY DIRECTS AND FOSTERS THE DEVELOPMENT OF CATHOLIC EDUCATION THROUGH FAITH PERMEATION.

ROLE OF THE LEADER:

An excellent Catholic leader is responsible for leading faith permeation by:

- Ensuring the religious dimension is inherent in all learning and the ethos of the school
- Cultivating a passion for truth; both natural and supernatural
- Committing to a moral and intellectual Catholic education
- Employing and developing teachers who display a clear understanding and commitment to Catholic Education
- Providing structured opportunities for staff to develop their abilities to infuse faith into curriculum and pedagogy
- Supervising teachers as they intentionally permeate faith in all subjects
- Encouraging critical thinking in the light of faith and values
- Supporting and promoting service projects that reflect Catholic teaching on social justice and charity.
- Advocating for a sacred perspective within a secular context

All of the learning outcomes in the Program of Studies contain a religious dimension. It is the right, responsibility and privilege of educators in Catholic schools to bring to consciousness the divine presence that resides in what is learned.

Permeation: Living Eucharist
in the Learning Community



Mark 4

AN EXCELLENT CATHOLIC LEADER IS CALLED TO BE A WITNESS AND AN AGENT OF HOPE, PROCLAIMING THE GOSPEL MESSAGE TO ALL PEOPLE, EVERYWHERE AND AT ALL TIMES.

ROLE OF THE LEADER:

An excellent Catholic leader, inspired by the love of God, witnesses to others a life lived in relationship with Jesus Christ by:

- Testifying, through words and actions to a life in Christ
- Modelling a lifestyle consistent with the teachings of the Catholic Church
- Participating actively in the life of the Church
- Attending Mass each week
- Praying personally and leading others in prayer
- Demonstrating a knowledge of faith
- Committing to personal faith development
- Employing a leadership style that serves others
- Developing a vision for evangelization and ministry

“Witness” made not only with words but also with daily life” should go beyond Church on Sunday. Rather, it should extend throughout the entire week in our homes, offices, schools, in places of entertainment, in hospitals, in prisons, in homes for the elderly, in places crowded with immigrants, in the city’s peripheries.

Pope Francis



Mark 5

AN EXCELLENT CATHOLIC LEADER ENSURES A COMMUNAL VISION; RECOGNIZING THAT GOD WILL BE FOUND WITH AND IN EACH OTHER.

ROLE OF THE LEADER:

An excellent Catholic leader is responsible for creating and leading a community of faith both within and beyond the school and school district by:

- Seeking unity inspired by the Holy Trinity
- Making intentional decisions to develop and support an active faith community
- Creating a culture that sets clear expectations for staff to fully participate in a life of faith
- Embedding sacramental routines (prayer, mass, liturgies, scripture and worship) and reminders in the culture of the school and district
- Nurturing relationships between the school and district and our bishops, priests and faith leaders
- Fostering reconciliation when needed
- Celebrating and affirming the community
- Developing priorities and protocols to address the needs of the marginalized
- Honoring parents/guardians as primary partners in education

Educational leaders are called to form “persons-in-community” environments in which one person’s problem is everyone’s problem and one person’s victory is everyone’s victory.

National Conference of Catholic Bishops



A CATHOLIC LEADER'S *Covenant*

To know God, to serve God, to love God

To answer the vocational call God has given

To lead so that others might be elevated

To act with integrity, justice, and compassion

To sacrifice in the service of all

To cherish those entrusted to us

To discern the will of God in all decisions and actions

To hope in tribulation and triumph

To model fidelity to truth and virtue

To unite with a spirituality of communion



Catholic leaders must bear witness to their vocation. In order to do so, they must lead lives of integrity and work as team builders, trusting, nurturing and recognizing the talents in others. They must be open to the newness of our age and be able to adapt to new directions. They must see the Gospel message as the root of their vocation, nourished by the sacraments to strengthen them for the leadership role.

Bishop Fred Colli

References

Bishop Fred Colli. (2010). Address to PQP Part 1 Candidates In Sudbury Catholic District School Board. *The Journey of Catholic Leadership*, (p. 15).

Catholic News Agency (2016). *Pope Francis: Be Witnesses of the Gospel Every Day*. Retrieved from <http://www.catholicnewsagency.com/news/pope-francis-be-witnesses-of-the-gospel-every-day-26051/>

Edmonton Catholic Schools (2002). *Permeation: Living Eucharist in the Learning Community*. Edmonton, AB: Edmonton Catholic Schools.

Miller, M. CSB (2006). *The Holy See's Teaching on Catholic Schools*.

Mulligan, J. T. (2006). *Catholic Education: Ensuring a Future*. Toronto, ON: Novalis Publishing.

National Conference of Catholic Bishops (NCCB). (1972). *To Teach As Jesus Did*. Washington, DC: United States Catholic Conference.

Ontario Council of Catholic Bishops (1993). *Fulfilling the Promise: The Challenge of Leadership*. Retrieved from <http://www.occb.on.ca/english/fulfilling.html>

Palestini, R. H. (2009). *Catholic School Administration: Theory, Practice, Leadership*. Lancaster, PA: ProActive Publications.

Supplementary Resources

Growing Forward, Catholic Education Symposium ACSTA 2014

The Excellent Catholic Teacher, CCSSA 2015

Five Essential Marks of Catholic Schools- Archbishop Miller 2006

Professional Practice Standards for School Authority Leaders - Alberta Education 2015

Draft School Leader Standard - Alberta Education 2016





Medicine Hat Catholic Board of Education
STUDENT CODE OF CONDUCT
Updated - November 28, 2016

1. Statement of Purpose

Medicine Hat Catholic Board of Education is committed to providing welcoming, caring, respectful and safe learning environments that respect diversity and a sense of belonging for students. (School Act Section 45.1)

The treatment of all persons with respect and dignity is a core value within the division. Expectations for student conduct arise from *School Act* requirements and the school district's Catholic values.

In our ministry, we value and celebrate:

- Teaching and living our Catholic faith
- Our Catholic traditions
- Our ability to offer a full range of educational programs for all students.
- That every child is a unique creation who possesses an intrinsic dignity which must always be respected
- Parents as primary educators. Parents have the first responsibility for the education of their children

2. Definition of Bullying

Section 1.1 (b.1) Alberta School Act, defines "bullying" as "repeated and hostile or demeaning behaviour by an individual in the school community where the behaviour is intended to cause harm, fear or distress to one or more other individuals in the school community, including psychological harm or harm to an individual's reputation."

3. Communication

Within the Medicine Hat Catholic Board of Education each school is expected to establish a student Code of Conduct and must be

- Made publicly available,
- Reviewed every year, and
- Provided to all staff, students and parents/legal guardians

4. The Alberta Human Rights Act

Our priority is to ensure that all of our students are provided with a respectful and compassionate school environment rooted in Catholic values and teachings.

This includes placing a strong value on having students conduct themselves properly at all times by respecting:

- All individuals and not engaging in discriminatory actions towards others because of their age, race, colour, place of origin, ancestry, family status, religious beliefs, physical disability, mental disability, gender, gender identity, gender expression, sexual orientation
- School authorities, and,
- School and division property, as well as, the property of others

The Alberta Human Rights Act, December 11, 2015:

The Alberta Human Rights Act prohibits discrimination on the basis of an individual's race, religious beliefs, colour, gender, gender identity, gender expression, physical disability, mental disability, age, ancestry, place of origin, marital status, source of income, family status or sexual orientation of that person or class of persons. Any behaviour that supports this discrimination is prohibited.

5. Shared Responsibility

Medicine Hat Catholic Board of Education recognizes that responsibility for student conduct is a shared responsibility between the Division, students, their parents/guardians and the broader community. The students in our Division are expected to behave in a manner that is courteous, respectful of others and supportive of the school philosophy and the goals of Catholic education.

6. Acceptable and Unacceptable Behavior

As required in Section 12 and Section 45.1(3) of the School Act the following behaviors are deemed acceptable and unacceptable within the Medicine Hat Catholic Board of Education.

i. Acceptable Behaviors

Students are expected to meet the requirements of the School Act (Section 12) which states a student shall conduct himself or herself so as to reasonably comply with the following code of conduct:

- Be diligent in pursuing the student's studies
- Attend school regularly and punctually
- Co-operate fully with everyone authorized by the board to provide education programs and other services
- Comply with the rules of the school
- Account to the student's teachers for the student's conduct
- Respect the rights of others
- Ensure that the student's conduct contributes to a welcoming, caring, respectful and safe learning environment that respects diversity and fosters a sense of belonging
- Refrain from, report and not tolerate bullying or bullying behaviour directed toward others in the school, whether or not it occurs within the school building, during the school day or by electronic means
- Positively contribute to the student's school and community

ii. Unacceptable Behaviors

The following are examples of unacceptable behaviors with regard to student conduct in schools that interfere with the establishment of welcoming, caring, respectful and safe learning environments that respect diversity and a sense of belonging for students:

- Defiance and disrespect
- Inappropriate use of language
- Behaviors that interfere with the learning of others and/or the school environment or that create unsafe conditions
- Open opposition to authority
- Bullying, including cyber-bullying
- Breaches of digital on-line safety
- Physical harm/assault
- Personal and/or sexual harassment
- Possession or use of weapons
- Drug, tobacco, e-cigarette, alcohol use, possession or distribution
- Inappropriate student dress
- Inappropriate use of mobile devices
- Theft and vandalism
- Threats or intimidation
- Extortion
- Discrimination

7. Progressive discipline plan

The school's discipline plan will outline the expectations, consequences and the progression of actions to be taken depending on the severity and/or frequency of the occurrences and will take into account the student's age, maturity and individual circumstances, and must ensure that support is provided for students who are impacted by inappropriate behaviour, as well as for students who engage in inappropriate behaviour. As well, parental and district involvement may be requested to support school discipline procedures.

At all times, teachers and administrators will use their professional judgment in applying consequences. Each school will keep a record of any disciplinary action taken with a student or group of students. Consequences are intended to have a positive effect on the student's journey through reconciliation, either formally or informally, with the school community and those affected by the student's behaviour.

We believe that members of our Catholic learning communities are called to educate our students to contribute their God-given talents in service to others. Our discipline practices focus on providing students with the opportunity for reconciliation that in turn leads to their return to community. Durham Catholic.

The following consequences are progressive in their degree of intervention and will be enacted depending on the frequency and severity of occurrences. They will be applied consistently and equally to all students, notwithstanding the individual differences of children and the uniqueness of specific circumstances and situations.

Progressive discipline is a whole school approach that utilizes a continuum of interventions, supports, and consequences, including:

- Prevention measures and initiatives
- Early and ongoing intervention strategies
- Strategies to address unacceptable behaviour

Interventions and consequences increase when:

- The concerning behavior is persistent
- The concerning behavior escalates
- There is a very serious infraction of the code of conduct

Interventions and consequences may include, but are not limited to, the following:

- Informal Conferences
- Restriction of Privileges
- Parent Conferences
- In School Suspensions
- Risk Assessment
- Suspension / Expulsion (AP 357)
- Student Redirection
- Behaviour Support Plan
 - Learner Support Plan
- Involvement of Instructional Services and Supports
- Involvement of External Services and Supports

The principal may involve police in disciplinary matters when criminal activity has become evident. When police are involved, the principal will conduct a separate, parallel investigation at the school level and provide disciplinary action separate from any criminal charges that may be issued.

8. Student support:

Support will be offered to students impacted by inappropriate behaviour and to those students who engage in inappropriate behaviour. This is significant because while the student code of conduct must address the consequences for inappropriate behaviour, it also ensures that support (not just consequences) is provided to those students who engage in unacceptable behaviour. Examples of how support could be provided to students who have engaged in unacceptable behaviour include mentoring, restorative processes, regular check-ins with teachers or schools counsellors, counselling, etc.

9. Consideration of student diversity:

The *School Act* requires that the student code of conduct address consequences for unacceptable behaviour and that these reasonable consequences take into account the student's age, maturity, and individual circumstances. The specific circumstances of the situation and of the student need to be taken into account when determining appropriate consequences. For example, any diverse needs that the student has – whether they are physical, behavioural, communicational, mental health, trauma, etc. must be considered.

Calgary Catholic Student Code of Conduct – Appendix
School Act, Section 15, 20, 23, 39, 40, 41, 43, 60, 61, 96, 113, 123, 124
Child, Youth and Family Enhancement Act
Freedom of Information and Protection of Privacy Act
Public Health Act
Social Development Act
Vital Statistics Act
Youth Justice Act
Section 23 Canadian Charter of Rights and Freedoms
Youth Criminal Justice Act
Freedom of Information and Protection of Privacy Regulation 200/95
Student Record Regulation 225/2006
Student Evaluation Regulation 177/2003
Children First Act Disclosure of Information Regulation 231/2013

Executive Assistant & Corporate Communications –Della Dewald
Board Meeting, December 13, 2016
December 2016

1. **Corporate Communications Advertising/Public Relations** - Exhibit a consistent message and increase community awareness.
- a. **MEDICINE HAT TOURISM RELOCATION GUIDE** – MHCBE will be featured in the tourism guide for our region; both in printed and online form.
Regular price for this publication is \$900+, we were able to negotiate a cost of \$395. We believe there is significant value in partnering with Tourism Medicine Hat.



b. December – IT'S CHRISTMAS TIME

- a. Radio Feature CHAT & MY96. student voice recorded). NO printed advertising was engaged with the MH News and MH Shopper in Dec 2016.
- b. <https://youtu.be/Wxs0WbQp3RU>

Its Christmas time...and Medicine Hat Catholic Schools are preparing our hearts for Jesus to come. We wait...and we pray... and we hope...so we can love more generously. Medicine Hat Catholic Schools wish you a happy and holy Christmas season. May the Lord bless you in the coming year...Merry Christmas!

c. December – IT'S CHRISTMAS TIME

c. CHAT TV – Christmas Feature

<https://www.youtube.com/watch?v=4D0w9V-GxVk>

SCRIPT: *Wishing you Faith, Love and Joy as you gather with family and friends during this most Holy Season. From the Board of Trustees, Alberta Teachers Association Local number 39, Staff and Students of the Medicine Hat Catholic Board of Education.*

d. 5th Trustee –Communication Strategy for Public Consultation for the addition of a Trustees for MHCBE

i. Beginning the Week of Dec 5th:

1. Backpack Circulation
2. Website / Social Media Notification
3. All Division Staff Notification
4. Parish Bulletins
5. Newspaper Publication
6. Host an OPEN HOUSE (Dec 13, 2016 from 5–6 pm) at the Catholic School Board Office (prior to the Dec Board Meeting)
7. Feedback from the general public open until Dec. 21, 2016

ii. Background: June 14, 2016 Catholic School Board Meeting.

Motion: "THAT the Board of Trustees for the Medicine Hat Catholic Board of Education contract with the Alberta School Board Association Consultant specializing in ward issues to perform the necessary work including public consultation to obtain the 5th Trustee".

e. Monsignor McCoy Modernization - Update in Board Bulletin Dec 2016

i. **MONSIGNOR MCCOY HIGH SCHOOL Modernization Update -**

The \$9.2M High School modernization is well underway. Through the summer and fall 2016 much of the school has seen significant improvement. The **Cosmetology Room was enlarged and improved; New Drama Room was completed** including a **new performance area** with increased instructional space and storage; the **New Foods Room is close to completion**, its new location and technology will provide tremendous learning opportunities including future apprenticeship opportunity in **Culinary Arts; Band Room will feature new practice areas** with modernized performance area; **Many classrooms have been newly painted** with modernized new heating and cooling systems as well as **upgraded wireless infrastructure** and **interactive white boards** with **a new Mac Lab** to **enhance CTS programming including Photography, Videography & Design Studies**. Future construction will see a **fully modernized Science Lab and refreshed Science & Math classrooms**. We are excited about the next phases of the modernization including the construction of a **Large Gymnasium, Fitness Area, Common-Area including Chapel Space, a Modernized Library, Construction & Mechanics Shop** and **Counseling Offices**. Throughout this modernization, careful planning has taken place to accommodate our students and staff. The modernization completion is proposed for the spring of 2017. Photos & Donation updates www.mhcbe.ab.ca under Latest News.





Donations as of Nov 2016 = \$229,425! Thank you!

Online donation available through [schoolcashionline](http://schoolcashionline.com)! Call us at 403.527.2292 to find out how you can help us build our school.

- FRIENDS OF MONSIGNOR MCCOY up to \$499
- BRICK DONOR \$500-\$999
- BRONZE DONOR \$1,000-\$9999
- SILVER DONOR \$10,000-\$19,999
- GOLD DONOR \$20,000*
- PLATINUM DONOR \$50,000*
- SPONSORSHIP \$75,000*
- ANONYMOUS & SILENT DONORS

Invest in OUR KIDS, invest in OUR SCHOOL!

www.mccoymodernization.ca

- ii. We recently did a Facebook post (screenshot below) with a “paid push” to our demographic area. We included the link to the Donations Form (paper) and (online) form via schoolcashionline
 1. <http://www.mhcbe.ab.ca/Donations%20to%20Date.php>
 2. <http://www.mccoymodernization.ca/invest.html>
- iii. We recently highlighted the construction update in our November Board Bulletin and on the Division website page; Board Bulletin included in the Parish Bulletins.
- iv. We have two sets of construction photos to-date; we are taking another set this week Thursday, Dec 1st, 2016; the photos will be posted to the web
 1. <http://www.mhcbe.ab.ca/Photo%20Gallery.php>
- v. Donations to-Date \$229,425

<http://www.mhcbe.ab.ca/Donations%20to%20Date.php>



Note: SANDFLY MARKETING - We are still working with Sandfly Marketing who is doing a fundraising push to our community to garner support for donations for the Modernization. Sponsorships and donations made before Dec. 31st, 2016 can claim the donation for tax benefits for 2016.

<http://www.mccoymodernization.ca/about.html>

MHCBE ...moving communications from good to great!

Derrian Hallas- School Communications and Social Media

Contact Information: derrian.hallas@mhcbe.ab.ca (403) 878-2017

#MHCatholic

Social Media Activity

566 to **582** "likes" on our **Facebook Page**

406 to **423** followers on **Twitter**

98 to **106** followers on **Instagram**



- Fine Arts Calendar
- Christmas Events Calendar
- MHCBE Christmas Message Banners
- Notre Dame Hockey Academy Video
- Mission Mexico Awareness
- Staff & parents can now submit photos to socialmedia@mhcbe.ab.ca
- St. John Paul II/ Monsignor McCoy Construction photos on division website

What Happened in November?

- Face II Face Retreats
- Catholic Education Sunday
- RAK Day #GoBeKind
- Remembrance Day
- Chat 94.5 Food Drive
- MHCBE 2nd Annual PD Day Chili Cook-Off
- First Sunday of Advent

Coming up in December:

- 2nd, 3rd, and 4th Sundays of Advent
- School Advent Masses
- Christmas Concerts



MH Catholic Schools @MHCatholic · Nov 4
 Passing on rays of sunshine ☀️ @RakDayMH #GoBeKind
 #community @StFrancisMH



CHAT 94.5 FM @CHAT945 · 2h

A big thank you to St. Louis School for collecting 872 lbs of food for the Food Bank. #ThanksaMillion#CHATFoodDrive



MH Catholic Schools @MHCatholic · 2h

The sweetest thing you'll see all day ❤️
 Mrs. Jackle's Grade 6 class singing
 Christmas Carols for residents at The
 Good Samaritan Society 🎄



MH Catholic Schools @MHCatholic · Nov 10
 "God wrote the scriptures through the
 hands of men, for us". @F2FMinistries
 @StMarys_MH #Godisgood



MH Catholic Schools @MHCatholic · 23h

MHCBE Central Office staff collected over
 1400lbs this year for the @CHAT945 food
 drive! #medhat #CHATFoodDrive
 @MedHatFoodBank



MH Catholic Schools @MHCatholic · 2m
 These #Advent kits are jam packed with
 beautiful stories and resources. Can't wait
 to share them with our schools #medhat
 #CatholicEducation



MH Catholic Schools @MHCatholic · Nov 24
 Last night the Board of Trustees
 approved:
 the Audited Financial Statements ✅
 the Fall Budget Update ✅
 the AERR/ 3 year Education Plan ✅



Medicine Hat Catholic Board of Education

November 23 at 1:34pm · 🌐

Thank you gracious donors for your investment in the modernization of our High School, we couldn't have done it without you!
 Donors to date: <http://www.mhcbe.ab.ca/Donations%20to%20Date.php>
 There is still time to be part of the legacy. Donations now accepted online:
<http://www.mccoymodernization.ca/invest.html...> See More



Medicine Hat Catholic Board of Education added 10 new photos — 🤔 feeling excited.

November 23 at 12:37pm · 🌐

155 days ago at the official sod turning, MHCBE was proud to announce the name of our new school in Southlands- St. John Paul II Elementary!

What has happened since the shovel hit the dirt? Here is a photo update.



Medicine Hat Catholic Board of Education at 📍 Hockey

Hounds Arena
 November 24 at 1:51pm · Medicine Hat · 🌐

St. Francis Xavier School's Annual Kinsmen Skate-a-Thon 🌨️ / look at these kids move!

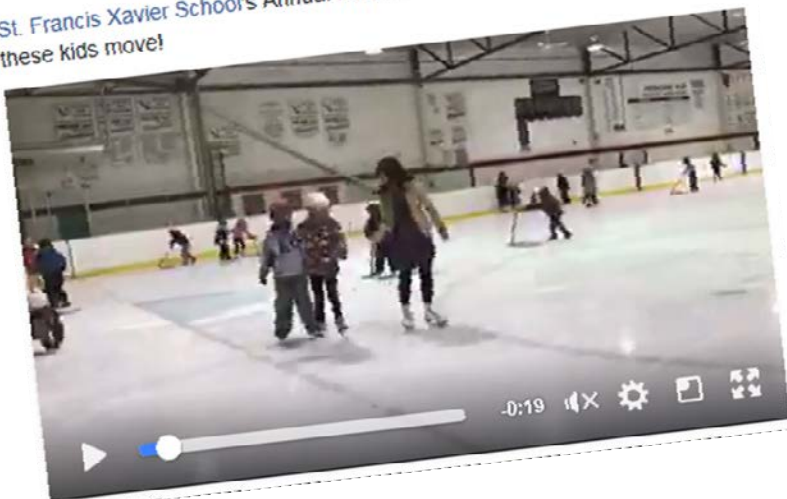

MH Catholic Schools @MHCatholic · 24h

Congratulations to @StLouis_MH's #TerrificKids for the month of November! Keep on being awesome. #medhat #happystudents



Medicine Hat Catholic Board of Education
 December 6 at 4:33pm · 🌐

MHCBE Trustees want to hear from YOU! Please join us next Tuesday, December 13th for our Fifth Trustee & Ward - Public Consultation Open House. Learn more <http://www.mhcbe.ab.ca/view.php...>

Medicine Hat Catholic Board of Education Fifth Trustee & Ward - Public Consultation Open House and Invitation to Comment

The Medicine Hat Catholic Board of Education is seeking to add a Fifth Trustee to the Board for the October 2017 Alberta School Board Election and to consult with our community about the Ward system. We want to hear from YOU!
Tuesday, December 13th 5-6pm
 1251- 1st Ave SW, Medicine Hat Catholic School Board Office



Come to the Open House or send your comments to communications@mhcbe.ab.ca by December 21st.
 More information at www.mhcbe.ab.ca 403.527.2292

MH Catholic Schools @MHCatholic · 4h

Students giving back ❤️ Great work to Mrs. Rozdeba's class from @StMarys_MH for their donations to the #SantaClausFund this year! #advent



Medicine Hat Catholic Board of Education
November 23 at 3:20pm · 🌐

St. Michael's School choir rehearsing for their big show tonight... They perform in the "Kids Chorus Concert" at 5:30 at Southminster Church in Lethbridge with the Lethbridge Symphony Orchestra. Break a leg!

Thanks to our awesome parents for submitting photos throughout the day.



Medicine Hat Catholic Board of Education added 8 new photos.

December 2 at 10:40am · 🌐

Students at Mother Teresa School had an incredible day learning to focus on people's abilities rather than disabilities in support of International Day of Persons with Disabilities. What a wonderful experience for our youth! #IDPD2016



MH Catholic Schools @MHCatholic · Nov 4

Our very own Teresa Sherk from @MotherTeresaMH is honoured as the Zone 6 #EdwinParr winner at the @ABSchoolBoards Awards night! #MHCatholic



For the 2nd year in a row this awesome group of @MMcCoy MH girls put smiles on faces at the Medicine Hat Hospital 🥰
❤️ @RakDayMH #GoBeKind



Medicine Hat Catholic Board of Education added 2 new photos.

November 25 at 4:10pm · 🌐

Mother Teresa Student Council members thinking of others this Christmas season. So nice to see our students volunteering 🇨🇦❤️



Medicine Hat Catholic Board of Education
November 26 at 11:52am · 🌐

École St. Thomas d'Aquin is all ready for the Advent season ❤️ Front foyer decorated and classroom Advent wreaths handed out. Oh, happy Monday.





Medicine Hat Catholic Schools

FINE ARTS EVENTS 2016-2017



SEPTEMBER 2016

21	Saints Go Marching In Presentation	St. Michael's School	9:00 am	Free
----	------------------------------------	----------------------	---------	------

OCTOBER 2016

19	Canadian Musical Theater Co.	St. Francis Xavier School	9:15 am	Free
19	Canadian Musical Theater Co.	St. Mary's School	11:00 am	Free
20	Canadian Musical Theater Co.	École St. Thomas d'Aquin	9:00 am	Free
20	Canadian Musical Theater Co.	Mother Teresa School	10:45 am	Free

NOVEMBER 2016

10	Remembrance Day Celebrations	All Schools		
18	Alberta Opera Hansel and Gretel	St. Mary's School	9:30 am	Free
18	Alberta Opera Hansel and Gretel	St. Michael's School	1:30 pm	Free
23	St. Michael's Kids Chorus Concert	Southminster Church, Lethbridge	5:30pm	\$5.00

December 2016

13	St. Mary's Christmas Concert	MH College Eresman Theatre	7:00pm	\$5.00 @ tixx.ca
15	St. Michael's Christmas Concert	MH College Eresman Theatre	7:00 pm	Free
19	Notre Dame Academy Christmas Gala	Notre Dame Academy	6:00 pm	Free
20	St. Patrick's K-2 Christmas Concert	St. Patrick's School	9:30 am/1:30pm/6:30pm	Food Donation
20	École St. Thomas Christmas Concert	Dream Centre	6:00 pm	Free
21	Mother Teresa Christmas Musical	Esplanade Theatre	7:00 pm	Silver Collection
21	St. Francis Xavier Christmas Concert	Dream Centre	7:00 pm	Free
21	St. Louis Christmas Concert	St. Louis School	6:30pm	Free
21	Monsignor McCoy Band and Silent Auction	Monsignor McCoy Drama Room	7:00 pm	Donation

JANUARY 2017

30	Andrew Scott Ukulele Workshop	École St. Thomas d'Aquin	TBA	Free
----	-------------------------------	--------------------------	-----	------

FEBRUARY 2017

16 & 17	Renelle Roy-French Folk Dance Workshops	École St. Thomas d'Aquin	All Day	Free
10	St. Mary's Fine Art's Gala	The Summit	7:00pm	By Donation
27	St. Michael's Choral Concert	St. Michael's School	TBA	Free

MARCH 2017

TBA	Daniel Gervais (French Fiddle Presentation)	École St. Thomas d'Aquin	TBA	Free
15	Canadian School Presenters "Jacob Moon"	St. Francis Xavier School	10:00 am	Free
15	Canadian School Presenters "Jacob Moon"	École St. Thomas d'Aquin	10:00 am	Free
		*At St. Francis Xavier School		
TBA	Rotary Music Festival	MH College	TBA	Free
26	Esplanade School Art Awards	Esplanade Theatre	1:00 pm	Free
29	13 the Musical	MH College Eresman Theatre	1:00 pm	Free
30	13 the Musical	MH College Eresman Theatre	1:00 pm/ 7:00 pm	\$15.00 @ tixx.ca
31	13 the Musical	MH College Eresman Theatre	11:00 am/ 7:00pm	\$15.00 @ tixx.ca

March 11- April 30 Division-Wide "School Art" on display @ the Esplanade

APRIL 2017

1	13 the Musical	MH College Eresman Theatre	7:00pm	\$15.00 @ tixx.ca
5	Shrek Jr. The Musical	Esplanade Theatre	7:00pm	\$12.00 @ tixx.ca
6	Shrek Jr. The Musical	Esplanade Theatre	7:00pm	\$12.00 @ tixx.ca
13	St. Michael's Passion Play	St. Michael's School	TBA	Free
13	St. Francis Xavier Stations of the Cross	St. Francis Xavier School	9:00 am	Free

MAY 2017

TBA	Division-Wide Schools "Spring Sing"	MH College Eresman Theatre	TBA	by Donation
18	St. Francis Xavier Talent Show	St. Francis Xavier School	10:30 am	Free
26	Spring Extravaganza Gala	St. Michael's School	TBA	Free
TBA	St. Patrick's Spring Concert	St. Patrick's School	TBA	Free

JUNE 2017

6	St. Mary's Spring Concert	MH College Eresman Theatre	7:00pm	\$5.00 @ tixx.ca
8	Monsignor McCoy Band and Choir Concert	TBA	7:00 pm	Donation
TBA	Mother Teresa Fine Arts Event	Esplanade	TBA	TBA
TBA	École St. Thomas Yearend Talent Show	École St. Thomas d'Aquin	TBA	Free

Inspiring Students through the Arts!

**Associate Superintendent Human Resources
Board Meeting, December 13, 2015**

1. 2017-2018 School Calendar

A draft 2017-2018 calendar has been presented to the Division Leadership Team. Administrators have been asked to share the calendar with staff and school councils and provide feedback. The Board is asked to provide feedback on the 2017-2018 draft school calendar. Based on the feedback received, an updated calendar will be presented to the board in the New Year.

Action: Board provide feedback on 2017-2018 draft school calendar

Recommendation: N/A

Attachment – Draft 2017-2018 school year calendar

2. School Visits

Over the past 2 weeks I have spent a great deal of time in the schools doing classroom visits with administrators. I have visited every school for a half a school day and have visited approximately 50 classrooms. The Board will be given an update as to the rationale for the visits, and some of the great things witnessed.

Action: N/A

Recommendation: N/A

Attachment: N/A

MEDICINE HAT CATHOLIC BOARD OF EDUCATION

Draft

SCHOOL YEAR CALENDAR - MEDICINE HAT

Draft

2017-2018

S M T W T F S							S M T W T F S							S M T W T F S																																																																																																																						
August														September														October																																																																																																								
<table><tr><td></td><td></td><td></td><td></td><td></td><td></td><td></td></tr><tr><td>13</td><td>14</td><td>15</td><td>16</td><td>17</td><td>18</td><td>19</td></tr><tr><td>20</td><td>21</td><td>22</td><td>23</td><td>24</td><td>25</td><td>26</td></tr><tr><td>27</td><td>28</td><td>29</td><td>30</td><td>31</td><td></td><td></td></tr></table>														13	14	15	16	17	18	19	20	21	22	23	24	25	26	27	28	29	30	31			<table><tr><td></td><td></td><td></td><td></td><td></td><td>1F</td><td>2</td></tr><tr><td>3</td><td>4</td><td>5s</td><td>6</td><td>7</td><td>8</td><td>9</td></tr><tr><td>10</td><td>11</td><td>12</td><td>13</td><td>14</td><td>15</td><td>16</td></tr><tr><td>17</td><td>18</td><td>19</td><td>20</td><td>21</td><td>22</td><td>23</td></tr><tr><td>24</td><td>25</td><td>26</td><td>27</td><td>28</td><td>29</td><td>30</td></tr></table>												1F	2	3	4	5s	6	7	8	9	10	11	12	13	14	15	16	17	18	19	20	21	22	23	24	25	26	27	28	29	30	<table><tr><td></td><td></td><td></td><td></td><td></td><td></td><td></td></tr><tr><td>1</td><td>2</td><td>3</td><td>4</td><td>5</td><td>6</td><td>7</td></tr><tr><td>8</td><td>9</td><td>10</td><td>11</td><td>12</td><td>13</td><td>14</td></tr><tr><td>15</td><td>16</td><td>17</td><td>18</td><td>19</td><td>20</td><td>21</td></tr><tr><td>22</td><td>23</td><td>24</td><td>25</td><td>26</td><td>27</td><td>28</td></tr><tr><td>29</td><td>30</td><td>31</td><td></td><td></td><td></td><td></td></tr></table>														1	2	3	4	5	6	7	8	9	10	11	12	13	14	15	16	17	18	19	20	21	22	23	24	25	26	27	28	29	30	31											
13	14	15	16	17	18	19																																																																																																																														
20	21	22	23	24	25	26																																																																																																																														
27	28	29	30	31																																																																																																																																
					1F	2																																																																																																																														
3	4	5s	6	7	8	9																																																																																																																														
10	11	12	13	14	15	16																																																																																																																														
17	18	19	20	21	22	23																																																																																																																														
24	25	26	27	28	29	30																																																																																																																														
1	2	3	4	5	6	7																																																																																																																														
8	9	10	11	12	13	14																																																																																																																														
15	16	17	18	19	20	21																																																																																																																														
22	23	24	25	26	27	28																																																																																																																														
29	30	31																																																																																																																																		
<table><tr><td>2</td><td>School PD Day - Teachers only</td></tr><tr><td>0</td><td>Instructional</td></tr><tr><td>2</td><td>Total</td></tr><tr><td>30th</td><td>First day for Teachers</td></tr></table>							2	School PD Day - Teachers only	0	Instructional	2	Total	30th	First day for Teachers	<table><tr><td>S</td><td>First day for Students</td></tr><tr><td>2</td><td>P.D.</td></tr><tr><td>18</td><td>Instruct.</td><td>F</td><td>Faith Formation</td></tr><tr><td>20</td><td>Total</td></tr></table>							S	First day for Students	2	P.D.	18	Instruct.	F	Faith Formation	20	Total	<table><tr><td>1</td><td>P.D.</td></tr><tr><td>20</td><td>Instructional</td></tr><tr><td>21</td><td>Total</td></tr></table>							1	P.D.	20	Instructional	21	Total																																																																																								
2	School PD Day - Teachers only																																																																																																																																			
0	Instructional																																																																																																																																			
2	Total																																																																																																																																			
30th	First day for Teachers																																																																																																																																			
S	First day for Students																																																																																																																																			
2	P.D.																																																																																																																																			
18	Instruct.	F	Faith Formation																																																																																																																																	
20	Total																																																																																																																																			
1	P.D.																																																																																																																																			
20	Instructional																																																																																																																																			
21	Total																																																																																																																																			
November														December														January																																																																																																								
<table><tr><td></td><td></td><td></td><td>1</td><td>2</td><td>3</td><td>4</td></tr><tr><td>5</td><td>6</td><td>7</td><td>8</td><td>9</td><td>10</td><td>11</td></tr><tr><td>12</td><td>13</td><td>14</td><td>15</td><td>16</td><td>17</td><td>18</td></tr><tr><td>19</td><td>20</td><td>21</td><td>22</td><td>23</td><td>24</td><td>25</td></tr><tr><td>26</td><td>27</td><td>28</td><td>29</td><td>30</td><td></td><td></td></tr></table>										1	2	3	4	5	6	7	8	9	10	11	12	13	14	15	16	17	18	19	20	21	22	23	24	25	26	27	28	29	30			<table><tr><td></td><td></td><td></td><td></td><td></td><td>1</td><td>2</td></tr><tr><td>3</td><td>4</td><td>5</td><td>6</td><td>7</td><td>8</td><td>9</td></tr><tr><td>10</td><td>11</td><td>12</td><td>13</td><td>14</td><td>15</td><td>16</td></tr><tr><td>17</td><td>18</td><td>19</td><td>20</td><td>21</td><td>22</td><td>23</td></tr><tr><td>24</td><td>25</td><td>26</td><td>27</td><td>28</td><td>29</td><td>30</td></tr><tr><td>31</td><td></td><td></td><td></td><td></td><td></td><td></td></tr></table>												1	2	3	4	5	6	7	8	9	10	11	12	13	14	15	16	17	18	19	20	21	22	23	24	25	26	27	28	29	30	31							<table><tr><td></td><td>1</td><td>2</td><td>3</td><td>4</td><td>5</td><td>6</td></tr><tr><td>7</td><td>8</td><td>9</td><td>10</td><td>11</td><td>12</td><td>13</td></tr><tr><td>14</td><td>15</td><td>16</td><td>17</td><td>18</td><td>19</td><td>20</td></tr><tr><td>21</td><td>22</td><td>23</td><td>24</td><td>25</td><td>26</td><td>27</td></tr><tr><td>28</td><td>29</td><td>30</td><td>31s</td><td></td><td></td><td></td></tr></table>								1	2	3	4	5	6	7	8	9	10	11	12	13	14	15	16	17	18	19	20	21	22	23	24	25	26	27	28	29	30	31s			
			1	2	3	4																																																																																																																														
5	6	7	8	9	10	11																																																																																																																														
12	13	14	15	16	17	18																																																																																																																														
19	20	21	22	23	24	25																																																																																																																														
26	27	28	29	30																																																																																																																																
					1	2																																																																																																																														
3	4	5	6	7	8	9																																																																																																																														
10	11	12	13	14	15	16																																																																																																																														
17	18	19	20	21	22	23																																																																																																																														
24	25	26	27	28	29	30																																																																																																																														
31																																																																																																																																				
	1	2	3	4	5	6																																																																																																																														
7	8	9	10	11	12	13																																																																																																																														
14	15	16	17	18	19	20																																																																																																																														
21	22	23	24	25	26	27																																																																																																																														
28	29	30	31s																																																																																																																																	
<table><tr><td>0</td><td>P.D.</td></tr><tr><td>21</td><td>Instructional</td></tr><tr><td>21</td><td>Total</td></tr></table>							0	P.D.	21	Instructional	21	Total	<table><tr><td>21st</td><td>Last day for students</td></tr><tr><td>1</td><td>P.D.</td></tr><tr><td>15</td><td>Instructional</td></tr><tr><td>16</td><td>Total</td></tr></table>							21st	Last day for students	1	P.D.	15	Instructional	16	Total	<table><tr><td>17</td><td>Instructional - 1st Semester HS</td></tr><tr><td>1</td><td>Instructional - 2nd Semester HS</td></tr><tr><td>1</td><td>P.D. E/M Elementary & Middle School</td></tr><tr><td>17</td><td>Jan. Instructional - Elem/Middle</td></tr><tr><td>18</td><td>Total</td></tr><tr><td>S</td><td>First day of 2nd Semester</td></tr></table>							17	Instructional - 1st Semester HS	1	Instructional - 2nd Semester HS	1	P.D. E/M Elementary & Middle School	17	Jan. Instructional - Elem/Middle	18	Total	S	First day of 2nd Semester																																																																																						
0	P.D.																																																																																																																																			
21	Instructional																																																																																																																																			
21	Total																																																																																																																																			
21st	Last day for students																																																																																																																																			
1	P.D.																																																																																																																																			
15	Instructional																																																																																																																																			
16	Total																																																																																																																																			
17	Instructional - 1st Semester HS																																																																																																																																			
1	Instructional - 2nd Semester HS																																																																																																																																			
1	P.D. E/M Elementary & Middle School																																																																																																																																			
17	Jan. Instructional - Elem/Middle																																																																																																																																			
18	Total																																																																																																																																			
S	First day of 2nd Semester																																																																																																																																			
February														March														April																																																																																																								
<table><tr><td></td><td></td><td></td><td></td><td>1</td><td>2</td><td>3</td></tr><tr><td>4</td><td>5</td><td>6</td><td>7</td><td>8</td><td>9</td><td>10</td></tr><tr><td>11</td><td>12</td><td>13</td><td>14</td><td>15</td><td>16</td><td>17</td></tr><tr><td>18</td><td>19</td><td>20</td><td>21</td><td>22</td><td>23</td><td>24</td></tr><tr><td>25</td><td>26</td><td>27</td><td>28</td><td></td><td></td><td></td></tr></table>											1	2	3	4	5	6	7	8	9	10	11	12	13	14	15	16	17	18	19	20	21	22	23	24	25	26	27	28				<table><tr><td></td><td></td><td></td><td></td><td>1</td><td>2</td><td>3</td></tr><tr><td>4</td><td>5</td><td>6</td><td>7</td><td>8</td><td>9</td><td>10</td></tr><tr><td>11</td><td>12</td><td>13</td><td>14</td><td>15</td><td>16</td><td>17</td></tr><tr><td>18</td><td>19</td><td>20</td><td>21</td><td>22</td><td>23</td><td>24</td></tr><tr><td>25</td><td>26</td><td>27</td><td>28</td><td>29</td><td>30</td><td>31</td></tr></table>											1	2	3	4	5	6	7	8	9	10	11	12	13	14	15	16	17	18	19	20	21	22	23	24	25	26	27	28	29	30	31	<table><tr><td></td><td></td><td></td><td></td><td></td><td></td><td></td></tr><tr><td>1</td><td>2</td><td>3</td><td>4</td><td>5</td><td>6</td><td>7</td></tr><tr><td>8</td><td>9</td><td>10</td><td>11</td><td>12</td><td>13</td><td>14</td></tr><tr><td>15</td><td>16</td><td>17</td><td>18</td><td>19</td><td>20</td><td>21</td></tr><tr><td>22</td><td>23</td><td>24</td><td>25</td><td>26</td><td>27</td><td>28</td></tr><tr><td>29</td><td>30</td><td></td><td></td><td></td><td></td><td></td></tr></table>														1	2	3	4	5	6	7	8	9	10	11	12	13	14	15	16	17	18	19	20	21	22	23	24	25	26	27	28	29	30					
				1	2	3																																																																																																																														
4	5	6	7	8	9	10																																																																																																																														
11	12	13	14	15	16	17																																																																																																																														
18	19	20	21	22	23	24																																																																																																																														
25	26	27	28																																																																																																																																	
				1	2	3																																																																																																																														
4	5	6	7	8	9	10																																																																																																																														
11	12	13	14	15	16	17																																																																																																																														
18	19	20	21	22	23	24																																																																																																																														
25	26	27	28	29	30	31																																																																																																																														
1	2	3	4	5	6	7																																																																																																																														
8	9	10	11	12	13	14																																																																																																																														
15	16	17	18	19	20	21																																																																																																																														
22	23	24	25	26	27	28																																																																																																																														
29	30																																																																																																																																			
<table><tr><td>2</td><td>P.D. Teachers' Convention</td></tr><tr><td>2*</td><td>Time in Lieu: Parent Teacher Conference</td></tr><tr><td>15</td><td>Instructional</td></tr><tr><td>17</td><td>Total</td></tr></table>							2	P.D. Teachers' Convention	2*	Time in Lieu: Parent Teacher Conference	15	Instructional	17	Total	<table><tr><td>1</td><td>P.D.</td></tr><tr><td>20</td><td>Instructional</td></tr><tr><td>21</td><td>Total</td></tr></table>							1	P.D.	20	Instructional	21	Total	<table><tr><td>1</td><td>P.D.</td></tr><tr><td>15</td><td>Instructional</td></tr><tr><td>16</td><td>Total</td></tr></table>							1	P.D.	15	Instructional	16	Total																																																																																												
2	P.D. Teachers' Convention																																																																																																																																			
2*	Time in Lieu: Parent Teacher Conference																																																																																																																																			
15	Instructional																																																																																																																																			
17	Total																																																																																																																																			
1	P.D.																																																																																																																																			
20	Instructional																																																																																																																																			
21	Total																																																																																																																																			
1	P.D.																																																																																																																																			
15	Instructional																																																																																																																																			
16	Total																																																																																																																																			
May														June														Semester																																																																																																								
<table><tr><td></td><td></td><td>1</td><td>2</td><td>3</td><td>4</td><td>5</td></tr><tr><td>6</td><td>7</td><td>8</td><td>9</td><td>10</td><td>11</td><td>12</td></tr><tr><td>13</td><td>14</td><td>15</td><td>16</td><td>17</td><td>18</td><td>19</td></tr><tr><td>20</td><td>21</td><td>22</td><td>23</td><td>24</td><td>25</td><td>26</td></tr><tr><td>27</td><td>28</td><td>29</td><td>30</td><td>31</td><td></td><td></td></tr></table>									1	2	3	4	5	6	7	8	9	10	11	12	13	14	15	16	17	18	19	20	21	22	23	24	25	26	27	28	29	30	31			<table><tr><td></td><td></td><td></td><td></td><td></td><td>1</td><td>2</td></tr><tr><td>3</td><td>4</td><td>5</td><td>6</td><td>7</td><td>8</td><td>9</td></tr><tr><td>10</td><td>11</td><td>12</td><td>13</td><td>14</td><td>15</td><td>16</td></tr><tr><td>17</td><td>18</td><td>19</td><td>20</td><td>21</td><td>22</td><td>23</td></tr><tr><td>24</td><td>25</td><td>26</td><td>27</td><td>28L</td><td>29*</td><td>30</td></tr></table>												1	2	3	4	5	6	7	8	9	10	11	12	13	14	15	16	17	18	19	20	21	22	23	24	25	26	27	28L	29*	30	<table><tr><td>1</td><td>2</td><td>Total</td></tr><tr><td colspan="3">Instructional Days</td></tr><tr><td>91</td><td>90</td><td>181</td></tr><tr><td colspan="3">High School</td></tr><tr><td>91</td><td>92</td><td>183</td></tr><tr><td colspan="3">Non-Instructional Days</td></tr><tr><td colspan="3">PD/School Closing Days: Elem/Middle Schools</td></tr><tr><td>8</td><td>7</td><td>15</td></tr><tr><td colspan="3">PD/School Closing Days: Msgr. McCoy</td></tr><tr><td>7</td><td>6</td><td>13</td></tr><tr><td colspan="3">Time in Lieu: Parent Teacher Conf.</td></tr><tr><td>0</td><td>2</td><td>2</td></tr><tr><td colspan="3">TOTAL</td></tr><tr><td></td><td></td><td>198</td></tr></table>							1	2	Total	Instructional Days			91	90	181	High School			91	92	183	Non-Instructional Days			PD/School Closing Days: Elem/Middle Schools			8	7	15	PD/School Closing Days: Msgr. McCoy			7	6	13	Time in Lieu: Parent Teacher Conf.			0	2	2	TOTAL					198
		1	2	3	4	5																																																																																																																														
6	7	8	9	10	11	12																																																																																																																														
13	14	15	16	17	18	19																																																																																																																														
20	21	22	23	24	25	26																																																																																																																														
27	28	29	30	31																																																																																																																																
					1	2																																																																																																																														
3	4	5	6	7	8	9																																																																																																																														
10	11	12	13	14	15	16																																																																																																																														
17	18	19	20	21	22	23																																																																																																																														
24	25	26	27	28L	29*	30																																																																																																																														
1	2	Total																																																																																																																																		
Instructional Days																																																																																																																																				
91	90	181																																																																																																																																		
High School																																																																																																																																				
91	92	183																																																																																																																																		
Non-Instructional Days																																																																																																																																				
PD/School Closing Days: Elem/Middle Schools																																																																																																																																				
8	7	15																																																																																																																																		
PD/School Closing Days: Msgr. McCoy																																																																																																																																				
7	6	13																																																																																																																																		
Time in Lieu: Parent Teacher Conf.																																																																																																																																				
0	2	2																																																																																																																																		
TOTAL																																																																																																																																				
		198																																																																																																																																		
<table><tr><td>1</td><td>P.D.</td></tr><tr><td>21</td><td>Instructional Days</td></tr><tr><td>22</td><td>Total</td></tr></table>							1	P.D.	21	Instructional Days	22	Total	<table><tr><td>1</td><td>P.D. E/M Elementary & Middle School</td></tr><tr><td>1*</td><td>P.D.</td></tr><tr><td>19</td><td>Instructional Elementary /Middle</td></tr><tr><td>20</td><td>Instructional High School</td></tr><tr><td>21</td><td>Total</td></tr><tr><td>L</td><td>Last day for Students</td></tr><tr><td>*</td><td>Last day for Teachers</td></tr></table>							1	P.D. E/M Elementary & Middle School	1*	P.D.	19	Instructional Elementary /Middle	20	Instructional High School	21	Total	L	Last day for Students	*	Last day for Teachers																																																																																																			
1	P.D.																																																																																																																																			
21	Instructional Days																																																																																																																																			
22	Total																																																																																																																																			
1	P.D. E/M Elementary & Middle School																																																																																																																																			
1*	P.D.																																																																																																																																			
19	Instructional Elementary /Middle																																																																																																																																			
20	Instructional High School																																																																																																																																			
21	Total																																																																																																																																			
L	Last day for Students																																																																																																																																			
*	Last day for Teachers																																																																																																																																			

www.mhcb.e.ab.ca

www.mhcbe.ab.ca

Secretary Treasurer
Board Report December 13, 2016 Public Meeting

1. 2016-17 Infrastructure Maintenance Renewal ('IMR') Plan

The board work plan has the approval of the IMR plan in December 2016. We will be deferring the approval of the plan to January 2017 to allow for further assessment on the requirements of certain facilities.

Recommendation: For information

Attachment: None

2. First Quarter 2016-17 Financial Update

The Board will receive the First Quarter 2016-17 Financial Update with a briefing on certain amendments.

Recommendation: For information and consideration

Attachment: Report to be distributed

3. Notre Dame Academy Outdoor Fitness Area

The Board received information from Notre Dame Academy regarding their request for an Outdoor Fitness Area to be purchased from the Internally Restricted Accumulated Surplus (the reserve). It was decided to defer the motion to the December 2016 Public Meeting.

In the fall budget update, the trustees were informed that the use from Internally Restricted Accumulated Surplus (the reserve) was budgeted for.

To finalize this process, the trustees are asked to approve the motion for the purchase of the Outdoor Fitness Equipment at Notre Dame Academy

Recommendation: That the Board of Trustees for the Medicine Hat Catholic Board of Education approve the use of \$50,000 from the Internally Restricted Reserve for the purchase of the Outdoor Fitness Equipment at Notre Dame Academy.

Attachment: Proposal included in November 2016 board package from Notre Dame Academy .

4. St. Mary's School – Budget Update

St. Mary's School has amended their budget for 2016-17 which now requires the use of \$16,500 from the Internally Restricted Accumulated Surplus.

They have identified two significant expenditures (totaling \$26,500) which were not included in their 2016-17 Fall Budget Update:

- a. \$11,500 - Desk and chairs – Desks and Chairs were ordered to replace two classrooms as many of their desks are in need of replacement and they need to start doing a couple of classrooms per year. Many classrooms have been using folding tables to “get by” as desks have been broken and discarded over the last few years. These desks were ordered in July, and arrived in early October.
- b. \$15,000 – School Purchased Teacher FTE – When scheduling for the 2016-17 school year, we planned to include 0.14 FTE from school based surplus. If they are unable to use accumulated surplus for this, they indicate they will need to reschedule and reduce the hiring they are currently doing to replace a teacher going on education leave January 9, 2017.

They have been able to “squeeze” the budget to some degree, but would like to take \$16,500 from the internally restricted accumulated surplus to accommodate the remainder of the above expenditures.

Recommendation: That the Board of Trustees for the Medicine Hat Catholic Board of Education approve the use of \$16,500 from the Internally Restricted Reserve for the use at St. Mary’s School for Furniture and Equipment and School Purchased Teacher FTE.

Attachment: None



PEAK
PLAY ENVIRONMENTS™

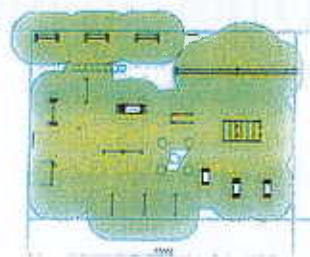
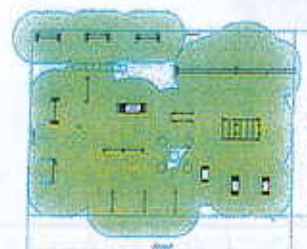
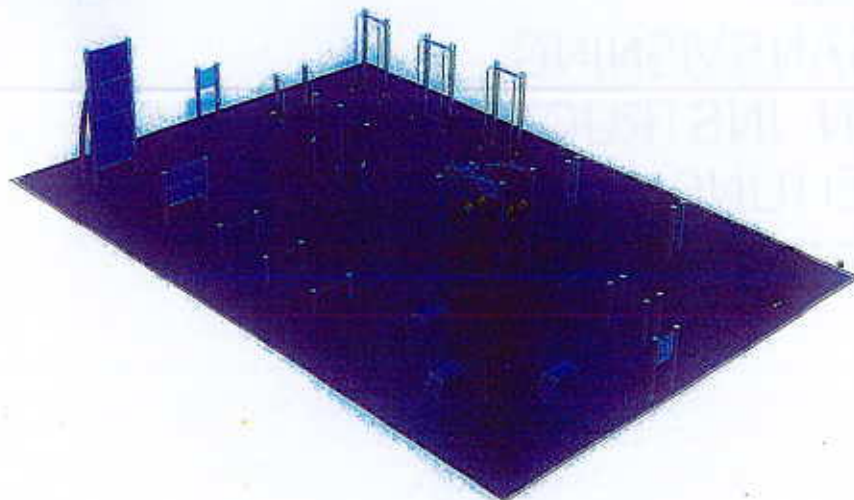

Product information

Product family: SPORT
Product name: FITNESS PARK M
Product code: 081325M

Technical information

Width:	13900 mm
Max. free fall height:	2620 mm
Height:	4125 mm
Length:	21000 mm
Impact area/ Length:	16970 mm
Impact area/ Width:	11300 mm
Minimum space/ Height:	4460 mm
Impact area:	124.4 m ²





PEAK
PLAY ENVIRONMENTS™

PARKOUR M





PEAK
PLAY ENVIRONMENTS LTD.

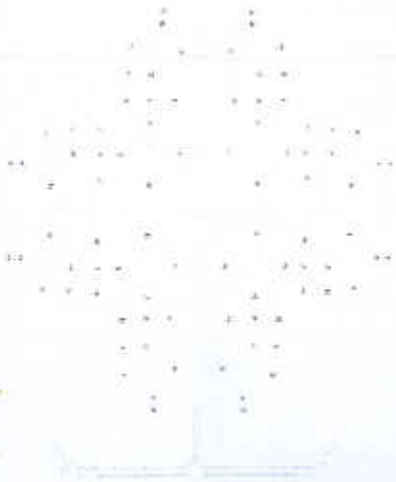

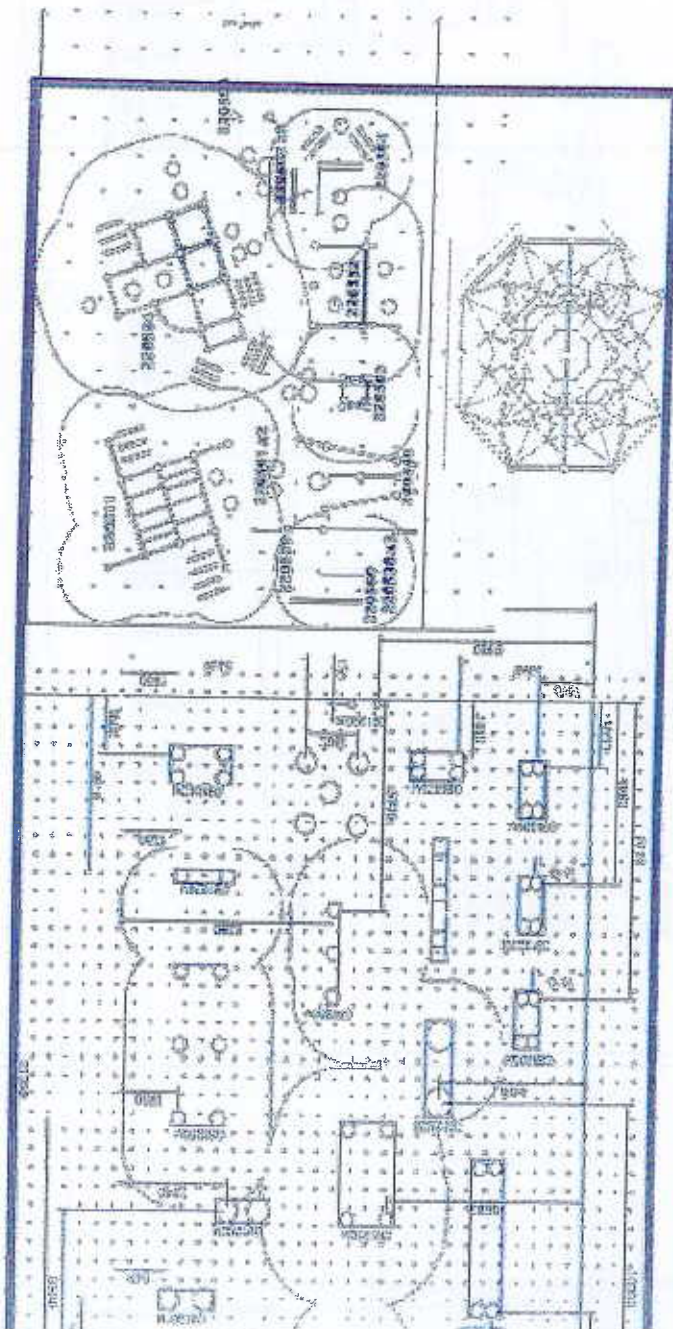

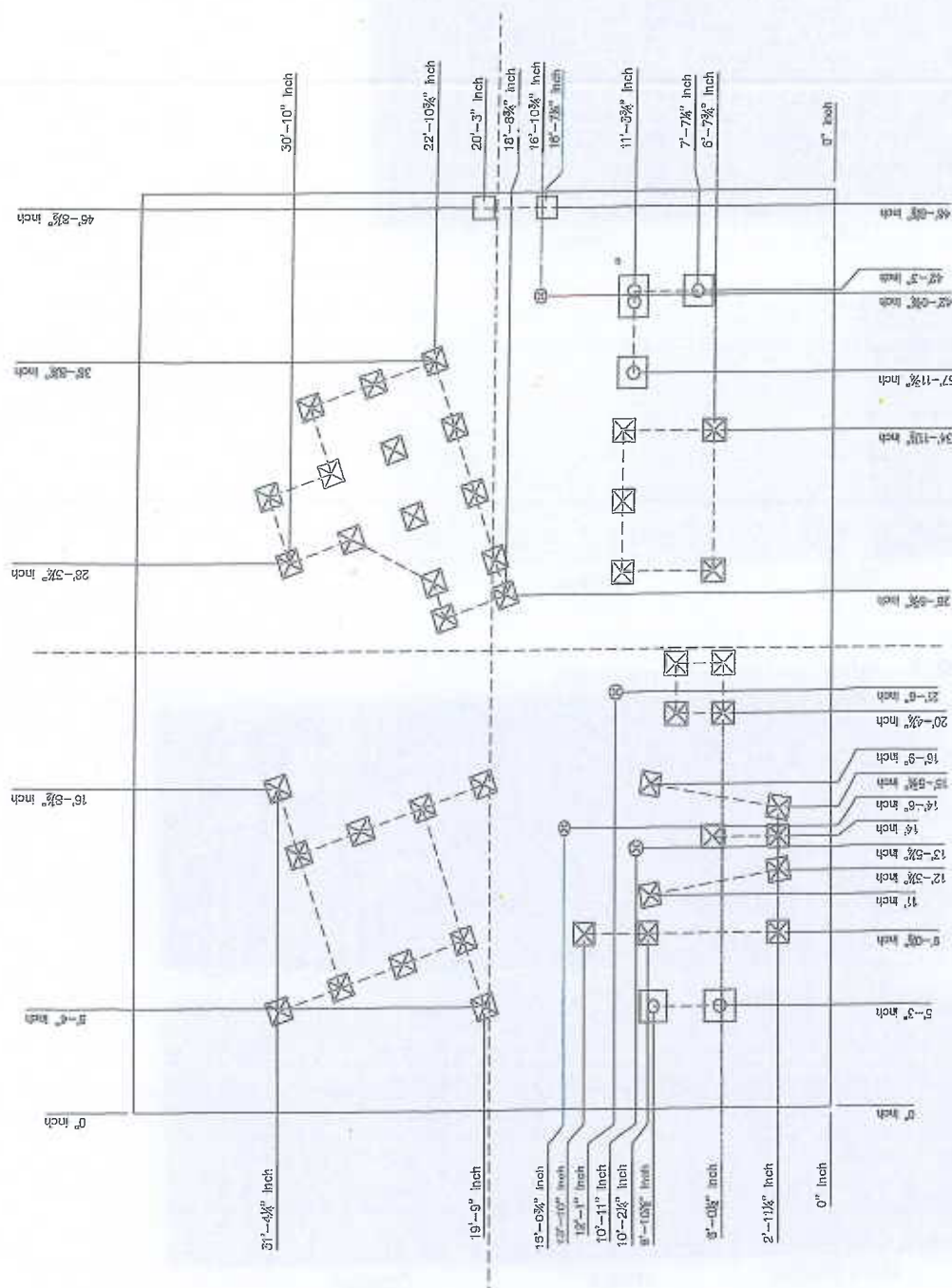



PEAK
PLAY ENVIRONMENTS™

WARRANTY

TRUESTOP Surfacing "in situ" poured-in-place rubber surfacing conforms to the formulations and standards of PlayQuest Recreation and provides a warranty against delamination, premature wear and colourfastness for a period of 1 year.

This warranty is in lieu of any other warranties expressed or implied, including, but not limited to any implied warranty of merchantability or fitness for a particular use. Note that some fading and wear of the pigment or painted surface are considered normal wear and tear. Vandalism or other willful acts are not included in this warranty.

The sole and exclusive remedy of the buyer against PlayQuest Recreation shall be for the replacement of the defective area for the time period of the warranty from the time of installation. No other remedy, including, but not limited to, incidental or consequential damages for lost profits, lost sales, injury to person or property, or any other incidental, or consequential loss, shall be available to the buyer or owner.

The TRUESTOP Surfacing "in situ" poured-in-place rubber surfacing performance is guaranteed to remain resilient and perform within the requirements of the ASTM F1292-99, ASTM F1292-04 and ASTM F1292-09 for the warranty period when field tested with a Triax2000 instrument from the same drop heights and at the same locations tested at the time of the initial PlayQuest installation and within the temperature range of -10C and 50C. The results of the drop tests at time of installation must comply with noted fall heights of the play equipment when field tested with a Triax2000 instrument. For this performance warranty to be in effect, a report outlining the locations, drop height and results must be forwarded to PlayQuest Recreation within 60 days of the initial PlayQuest installation and be done by an independent and impartial testing company.

BOARD Report December 13, 2016

1. PUF Application to Alberta Education

- The PUF budget including the planned expenses for the school year and all the children qualifying for PUF (to date we have 144 children on the caseload) with their hours, days and sites attending was due to Alberta Education at the end of November.
- The expenses include costs for learning assistants (currently 63), speech language pathologists (7) and their assistants (4) occupational therapist (1) and their assistants (2), physical therapists (2) and their assistant (1), behavior support (3), family orientated program staff who support IPP goals in the home (2), child psychologists (2), PUF teachers (3), admin support (1), travel and phone allowance costs (for 13 staff), supply costs, substitute learning assistant costs and my wage.
- Key Point- Children can still qualify for PUF support this school year after the budget and application has been submitted. The process involves us asking Alberta Education to send the application back to us so we can add new children and change the costs. We have up until **February 1, 2017** to do this.

Link: <http://www.mhcb.e.ab.ca/Curriculum.php>

Curriculum

Diocese & Parish Information

Family Life

Curriculum

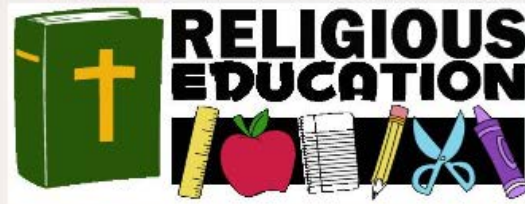

At Medicine Hat Catholic we strive to ensure that our shared faith is the motivation behind every activity that takes place in our schools. Our children learn about Catholic contributions in science, explore religious themes in literature, learn about issues of social justice and help to serve those in need. Our children pray regularly throughout the school day, gather together for worship, observe the seasons of the liturgical calendar, and are encouraged to see the hand of God in every aspect of life. Our children are taught the inherent dignity of human life, and encouraged to recognize themselves as God's work of art.

Medicine Hat Catholic offers a varied and high standard of programming; however our purpose extends beyond the imparting of information of the development of skills. As you can see from the grade level outcomes, we exist to educate the whole child, to form the whole person, to nourish each person as a child of God.

"How beautiful are the footsteps of those who bring good news." Romans 10:15

Parish-School-Family Link to New RE Curriculum Grade 1 & 2:



- [Family Link](#)
- [Parish Link](#)

Please contact your child's teacher for username and password.

- [Grade Outcomes and Summaries](#)
- [High School Religion Summary](#)
- [Religion Key Words](#)
- [Religious Education In Kindergarten](#)
- [Sacraments Within The Curriculum](#)



Medicine Hat Catholic Board of Education

Volunteer Information for **TIME, TALENT & INTEREST LIST**

Medicine Hat Catholic schools are looking for ways to involve the parish community. The School Division believes that volunteers can have a significant and positive impact on the educational environment and so encourages their involvement in schools. We are creating a Time, Talent and Interests list so we can call on people for specific opportunities. These experiences will not only be rewarding and worthwhile for the volunteer, but a blessing for the children as well!

NAME

EMAIL

HOME PHONE NUMBER

CELL PHONE NUMBER

Days and Times Available to volunteer:

- ☐ Monday ☐ Tuesday ☐ Wednesday ☐ Thursday ☐ Friday
- ☐ Morning ☐ Afternoon ☐ Specific Time _____

I am interested in helping with (check all that apply)

- ☐ Teach students to play games
- ☐ Reading to or with students
- ☐ Crafts (describe) _____
- ☐ Library Help
- ☐ Artwork (describe) _____
- ☐ Athletics/Coaching (describe) _____
- ☐ Making a presentation to a class _____
- ☐ Building (i.e. bird houses and other small projects)
- ☐ Dancing (describe) _____
- ☐ Sewing/Knitting _____
- ☐ Clubs (describe) _____
- ☐ Share a talent, interest of hobby (describe) _____
- ☐ Music (describe) _____

I am interested in volunteering at the following schools:

- ☐ École St. Thomas d'Aquin ☐ Monsignor McCoy ☐ Mother Teresa ☐ Notre Dame Academy
- ☐ St. Francis Xavier ☐ St. Louis ☐ St. Mary's ☐ St. Michael's ☐ St. Patrick's

Volunteering with Medicine Hat Catholic Schools may require that you have a current Police Information Check and a Child Intervention Record Check in accordance with **Administrative Procedure 490-VOLUNTEERS**. If you have any questions, please call Jill Wilkinson @ 403-502-8353. Thank you!

Signature _____ **Date** _____

Comments: _____

The Season of Advent



"The people who walked in darkness have seen a great light" Isaiah 9:2a

What is Advent?

Advent is a time set aside for us at the beginning of the church year when hope and joy should fill our hearts as we know that Jesus, our Saviour, has come and will come again to give us life everlasting.

Advent calls us to rediscover the reasons for our belief in Jesus as the Christ. It is a season meant to encourage a person and profound interior journey of waiting in our hearts and homes.

The word Advent comes from the Latin *advenio*, "to come to," and refers to the coming of Christ

What happens during this time?

A symbol central to our waiting time is the Advent wreath. The wreath is circular, reminding us that God's love is never ending. Four candles (3 purple and 1 pink) are placed on the wreath to symbolize the four Sundays before Christmas. This is a time of waiting and preparing for Jesus. Purple is the colour of royalty – to prepare for the King. Each week a new candle is lit and a prayer is said.

The purple candles remind us that Advent is really a "Little Lent" where we prepare by doing good for others. At this time of year, all of our school are involved in charitable acts and helping others less fortunate than ourselves. For example, Angel Trees, Food Hampers, Santa Claus Fund donations and much more.

When is Advent?

Advent extends over four Sundays before Christmas. This year, the first Sunday of Advent is November 27th, the second Sunday of Advent is December 4th, the third Sunday of Advent is December 11th, and the fourth Sunday of Advent is December 18th.

Advent Prayers:

- Week 1: O God, during this Advent season, help me prepare for the coming of your Son. May I remember to show kindness to those around me. Amen.
- Week 2: Jesus, when you came you brought peace to the world. May I always be a sign of your peace. Amen.
- Week 3: Dear Lord, Advent is a season of joy. Help me serve you always with a happy heart. Amen.
- Week 4: Heavenly Father, when you sent your Son to our world, everyone rejoiced. During the Advent and Christmas seasons, fill my heart with love for you. Amen.

In our Catholic Schools:

Our Catholic schools will have a special celebration every day to acknowledge the season of Advent. Each classroom has their own Advent wreath and candles where they light the candles, sing and pray.

School Advent Masses:

- December 2nd 10:00am: St. Michael's & St. Louis School at St. Patrick's Church
- December 7th 10:30am: École St. Thomas d'Aquin & Mother Teresa School at Holy Family Parish
- December 16th 9:45am: St. Patrick's School & Notre Dame Academy at Holy Family Parish
- December 16th 11:00am: St. Francis Xavier School at St. Patrick's Church
- December 20th 10:00am: St. Mary's School at Holy Family Parish